

LOCATION PLAN 1/1250

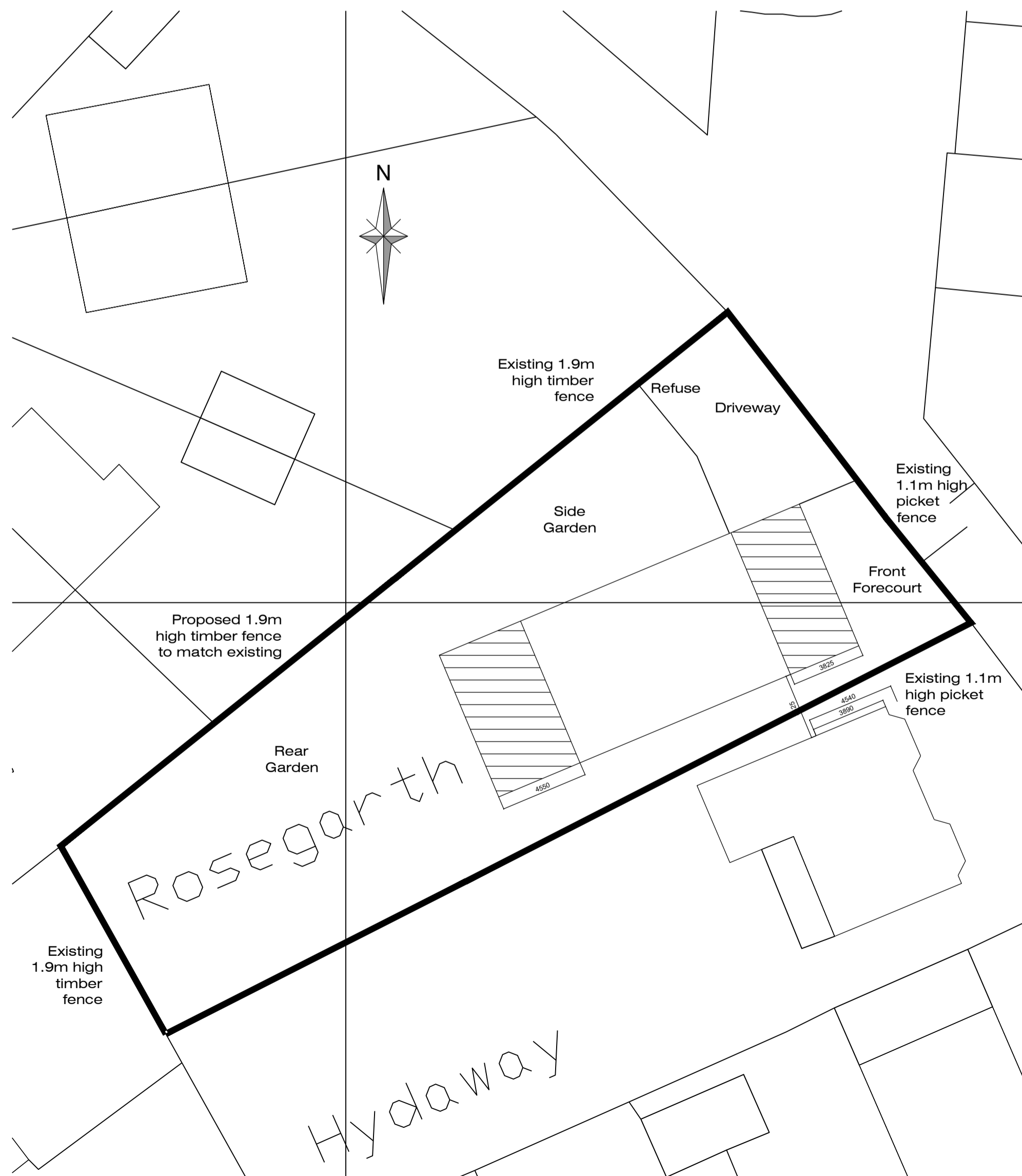

PROPOSED BLOCK PLAN 1/200

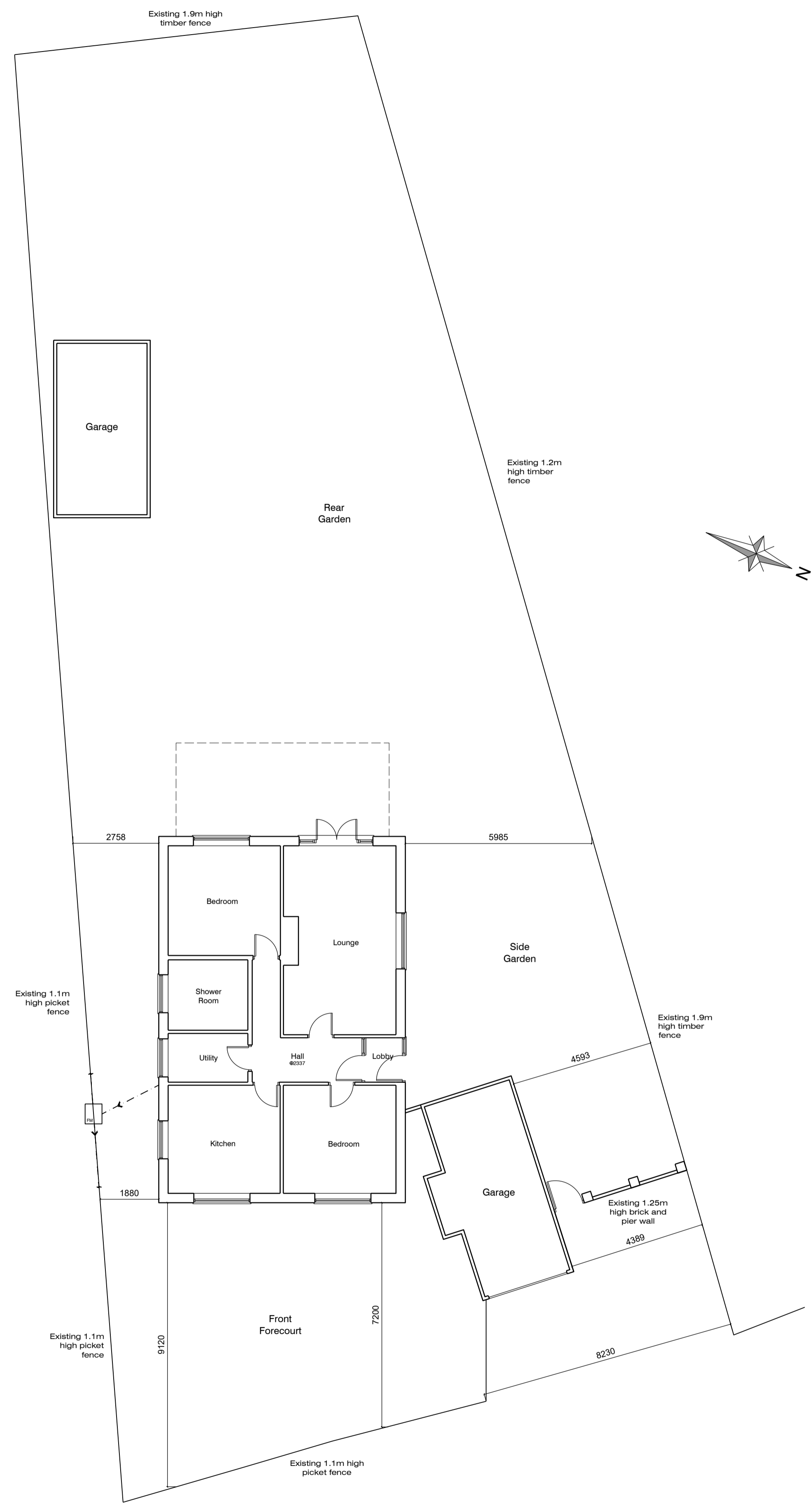

EXISTING SITE PLAN

AMENDED
DRAWING

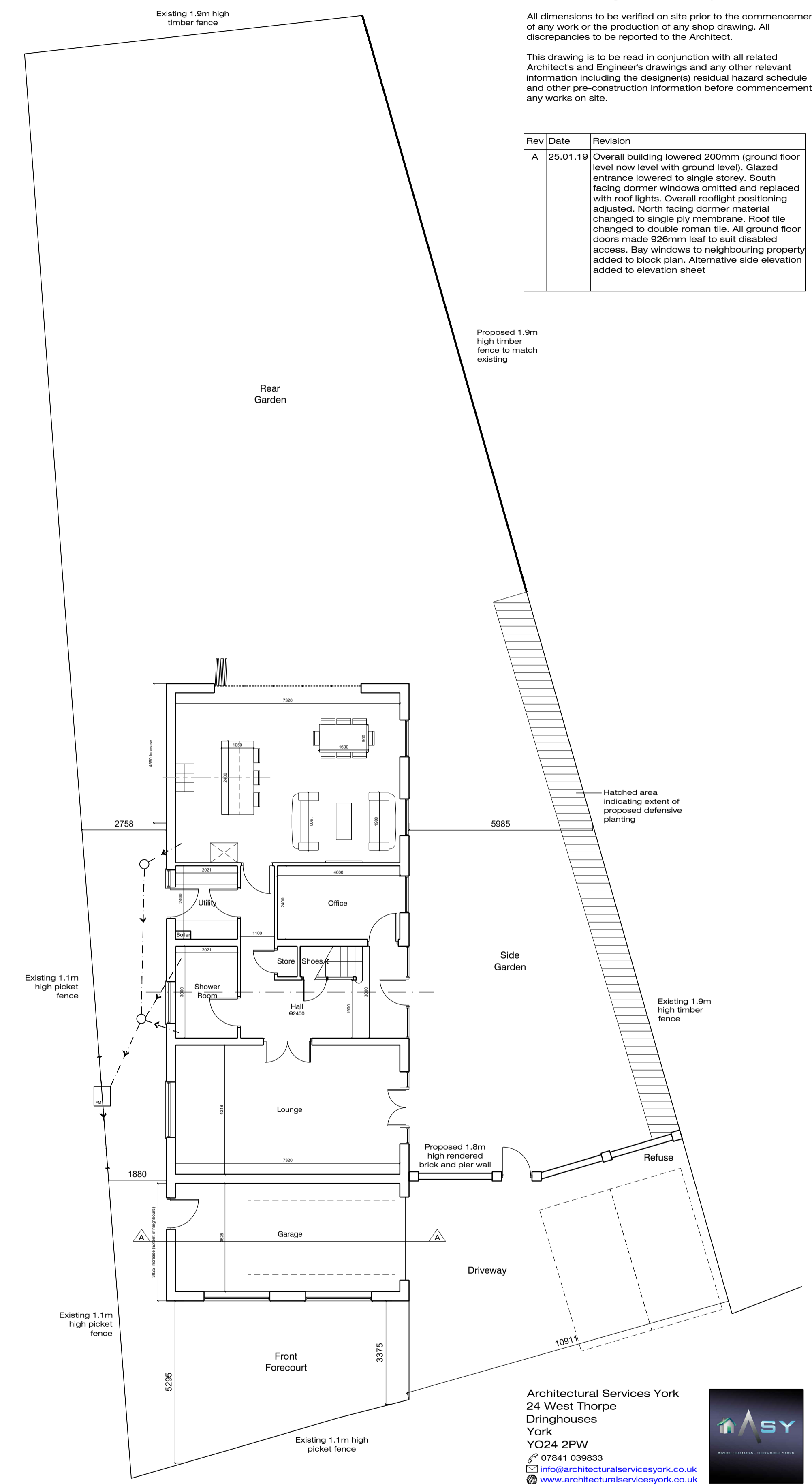

PROPOSED SITE PLAN

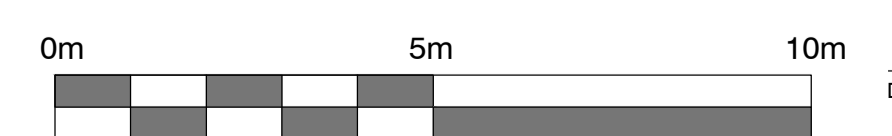

Notes
Do not scale, use figured dimensions only.
All dimensions to be verified on site prior to the commencement of any work or the production of any shop drawing. All discrepancies to be reported to the Architect.
This drawing is to be read in conjunction with all related Architects and Engineers drawings and any other relevant information including the designer(s) residual hazard schedule and other pre-construction information before commencement of any works on site.

Rev	Date	Revision
A	25.01.19	Overall building lowered 200mm (ground floor level now level with ground level). Glazed entrance lowered to single storey. South facing dormer windows omitted and replaced with roof lights. Overall rooflight positioning adjusted. North facing dormer material changed to single ply membrane. Floor tile changed to double roman tile. All ground floor doors made 926mm leaf to suit disabled access. Bay windows to neighbouring property added to block plan. Alternative side elevation added to elevation sheet.

Proposed 1.9m high timber fence to match existing

Hatched area indicating extent of proposed defensive planting

Architectural Services York
24 West Thorpe
Dringhouses
York
YO24 2PW
07841 039833
info@architecturalservicesyork.co.uk
www.architecturalservicesyork.co.uk



Project
Proposed Development at Rose Garth, York Road, Barby YO8 5JP

Drawing Title
Existing & Proposed Site Plan & Block Plan

Scale 1: 100 @ A1 Date SEPT/ 2018

Drawing No. TR01/ 03 Rev. A